

CONTENT

1. Pallet truck description	6
1.1. Application.....	6
1.2. Assemblies.....	6
1.3. Identification points and data plates.....	9
1.4. Standard version specifications.....	10
2. Transport and commissioning	15
2.1. Using the pallet truck for the first time.....	15
2.2. During brake-in.....	15
3. Operation	16
3.1. Safety regulations for the operation of pallet trucks.....	16
3.2. Operate and run the pallet truck.....	17
4. Battery maintenance & charging	20
4.1. Safety regulations for handling lead-acid batteries.....	20
4.2. Battery type & dimensions.....	20
4.3. Charging the battery.....	20
4.4. Battery removal and installation.....	22
4.5. Battery maintenance.....	22
4.6. Battery disposal.....	23
5. Pallet truck maintenance	23
5.1. Operational safety and environmental protection.....	23
5.2. Maintenance safety regulations.....	24
5.3. Servicing and inspection.....	25
5.4. Decommissioning the industrial pallet truck.....	27
5.5. Safety checks to be performed at regular intervals and following any unusual incidents.....	28
5.6. Final decommissioning, disposal.....	29
6. Troubleshooting	29

Correct use and application

The “Guidelines for the Correct Use and Application of Industrial Pallet trucks” (VDMA) are supplied with the pallet truck. The guidelines form part of these operating instructions and must be respected. National regulations apply in full. The pallet truck described in the present operator manual is an industrial pallet truck designed for lifting and transporting load units. It must be used, operated and serviced in accordance with the present instructions. Any other type of use is beyond the scope of application and can result in damage to personnel, the pallet truck or property. In particular, avoid overloading the pallet truck with loads which are too heavy or placed on one side. The data plate attached to the pallet truck or the load diagram are binding for the maximum load capacity. The industrial pallet truck must not be used in fire or explosion endangered areas, or areas threatened by corrosion or excessive dust.

Proprietor responsibilities

For the purposes of the present operator manual the “proprietor” is defined as any natural or legal person who either uses the industrial pallet truck himself, or on whose behalf it is used. In special cases (e.g. leasing or renting) the proprietor is considered the person who, in accordance with existing contractual agreements between the owner and user of the industrial pallet truck, is charged with operational duties.

The proprietor must ensure that the pallet truck is used only for the purpose it is intended for and that danger to life and limb of the user and third parties are excluded. Furthermore, accident prevention regulations, safety regulations and operating, servicing and repair guidelines must be followed. The proprietor must ensure that all pallet truck users have read and understood this operator manual. Failure to comply with the operator manual shall invalidate the warranty. The same applies if improper work is carried out on the pallet truck by the customer or third parties without the permission of the manufacturer’s customer service department.

Attaching accessories

The mounting or installation of additional equipment which affects or supplements the performance of the industrial pallet truck requires the written permission of the manufacturer. In some cases, local authority approval shall be required. Approval of the local authorities however does not constitute the manufacturer’s approval.

1. PALLET TRUCK DESCRIPTION

1.1. Application

The pallet truck is designed to transport goods on level surfaces. It can lift open bottom or diagonal board pallets as well as roll cages beyond the area of the load wheels. Suitable ambient temperature is 5 °C to 40 °C.

If the pallet truck is used for extended periods of time in ambient temperatures below 5 °C, cold storage, or in extreme conditions with temperature and humidity changes, you must install additional special equipment, and obtain permission from the manufacturer.

1.2. Assemblies

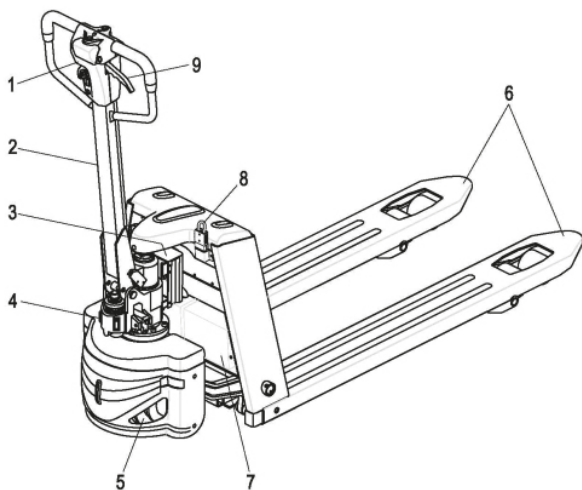

Item	Component
1	Tiller head
2	Tiller
3	Controller cover
4	Pump
5	Driving wheel

Item	Component
6	Fork
7	Battery
8	Battery disconnecting
9	Lowering lever

1.2.1. Control handle

Item	Control/display	Function
11	Key switch (option)	Switches control current on and off
12	Boatlike switch	Switches control current on and off
13	"Forward" button	Travel forward
14	"Backward" button	Travel backward
15	Collision safety switch	Safety function which, when activated, forces the pallet truck to reverse until the switch returns to neutral position
16	"Horn" button	Triggers a warning signal
17	Battery discharge indicator	Display battery residual capacity

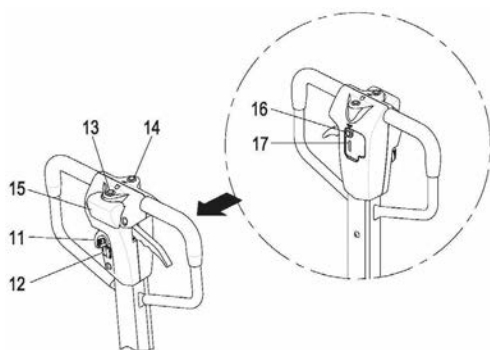

1.2.2. Key switch

1. Rocker switch

Switches control current on and off.

The pallet truck power supply is turned off when the key = "O".

The pallet truck power supply is turned on when the key = "I".

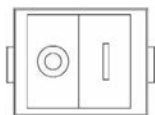

2. Key switch

Switches control current on and off.

The pallet truck power supply is turned off when the key is in the "off"

position. The pallet truck power supply is turned on when the key is in the "on" position.



Removing the key prevents the pallet truck from being switched on by

unauthorised personnel.

1.2.3. Battery discharge indicator

When the pallet truck is switched ON using the key switch, the battery charge status is displayed:

- the most left-hand LED under number "1" lights up when the battery is properly charged.
- when the battery charge changes by use, the first LED will go out and the next one will light up indicating a lower level of charge than maximum. Each LED represents 10% of charge.
- when the second to last LED is reached, it will not light up continuously, but it will flash. This indicates the battery charge has been used for 70% and the "charge reserve" has been reached.
- as soon as 80% charge has been used, both the last and second to last LED will flash alternately indicating the battery needs charging.

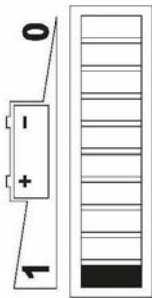

The battery discharge indicator has a memory function, it can remember the battery power after the power is turned off, and next time the power is turned on, it will show the power value stored in it's memory. If you to want reset the battery discharge indicator, please turn on the key after properly charging.

Low-voltage Protection

This vehicle has a low-voltage protection function.

When the battery voltage is less than 80%, the driving speed will be limited. In this case, the battery needs to be charged.

1.4. Standard version specifications

Technical modifications and additions reserved.

1.4.1. Performance data for standard pallet trucks

UK version:

Item	Description		Parameter	Unit
Q	Load capacity		3300	lbs
C	Load center		23,62	in
	Travel speed	loaded	3,5	km/h
		unloaded	4,0	km/h
		loaded	10	m/s
		unloaded	10	m/s
	Maximum gradeability, S_{25} min	loaded	2	%
		unloaded	6	%
	Service brake		electromagnetic	
	Service weight	incl battery	308	lbs
	Axle loading, loaded	operator/load side	1188/2420	lbs
	Axle loading, unloaded	operator/load side	242/66	lbs
	Motor	drive	0,65	kW
		lift	manual	
	Tyre type, operator/load side		PU/ PU	
	Tyre size, operator side		Ø210 x 70	mm
	Tyre size, load side		2-Ø80 x 60	mm
	Battery	type	maintenance-free battery	
		voltage/rated capacity (5h)	2 x 12/ 30	V/Ah
		weight	20,9 x 2	lbs
	Sound level at operator's ear		74	dB(A)

European version:

Item	Description		Parameter	Unit
Q	Load capacity		1500	kg
C	Load center		600	mm
	Travel speed	loaded	3,5	km/h
		unloaded	4,0	km/h
		loaded	10	m/s
		unloaded	10	m/s
	Maximum gradeability, S_{25} min	loaded	2	%
		unloaded	6	%
	Service brake		electromagnetic	
	Service weight	incl battery	140	kg
	Axle loading, loaded	operator/load side	540/1100	kg
	Axle loading, unloaded	operator/load side	110/30	kg
	Motor	drive	0,65	kW
		lift	manual	
	Tyre type, operator/load side		PU/ PU	
	Tyre size, operator side		Ø210 x 70	mm
	Tyre size, load side		2-Ø80 x 60	mm
	Battery	type	maintenance-free battery	
		voltage/rated capacity (5h)	2 x 12/ 30	V/Ah
		weight	9,5 x 2	kg
	Sound level at operator's ear		74	dB(A)

1.4.2. Dimensions

UK version:

Item	Description		Parameter	Unit
X	Load distance		34,76/37,24	in
Y	Wheel base		47,68	in
h3	Lift height		4,53	in
b11	Tread	load side	16,14	in
h13	Fork height	lowered	3,35	in
h14	Height of tiller arm in operating position	min	19,69	in
		max	51,18	in
L1	Overall length		62,20	in
L2	Length to face of forks		16,93	in
b1	Overall width		22/27	in
s	Fork dimensions	Thickness	1,97	in
e		Width	5,91	in
L		Length	45	in
b5	Fork spread		22/27	in
m2	Ground clearance		1,38	in
Wa	Outer turning radius		54,33	in
Ast	Aisle width (1)	1000 x 1200 pallet crossways	72,05	in
		800 x 1200 pallet lengthways	72,05	in

(1) Including safety distance a = 7,87 in

European version:

Item	Description		Parameter	Unit
X	Load distance		883/945	mm
Y	Wheel base		1211	mm
h3	Lift height		115	mm
b11	Tread	load side	410	mm
h13	Fork height	lowered	85	mm
h14	Height of tiller arm in operating position	min	500	mm
		max	1300	mm
L1	Overall length		1580	mm
L2	Length to face of forks		430	mm
b1	Overall width		580/685	mm
s	Fork dimensions	Thickness	50	mm
e		Width	150	mm
L		Length	1143	mm
b5	Fork spread		560/685	mm
m2	Ground clearance		35	mm
Wa	Outer turning radius		1380	mm
Ast	Aisle width (1)	1000 x 1200 pallet crossways	1830	mm
		800 x 1200 pallet lengthways	1830	mm

(1) Including safety distance a = 200 mm

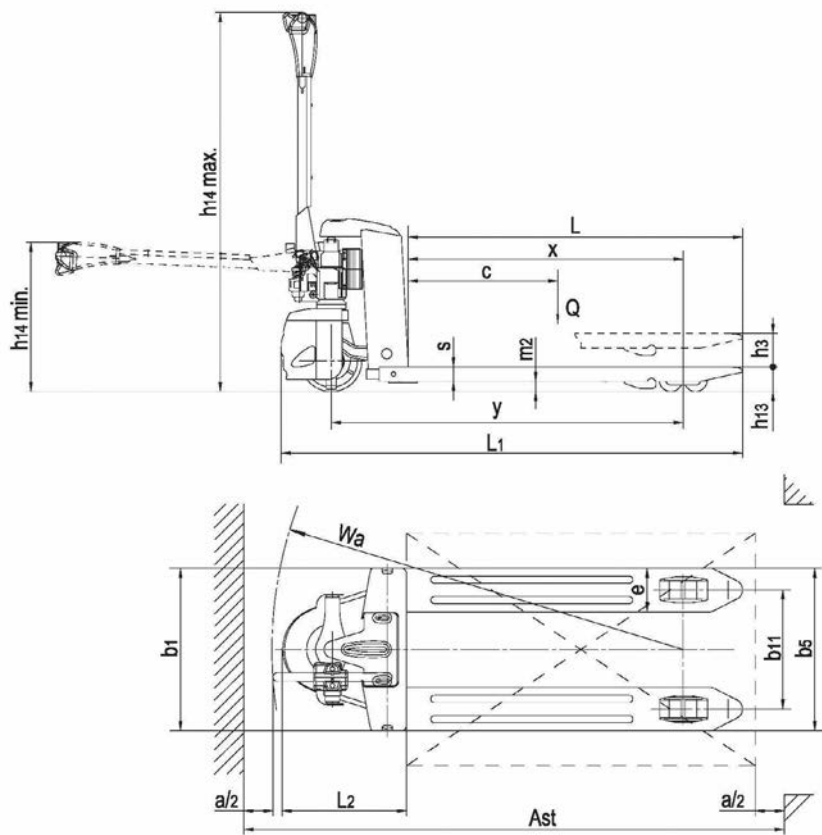

2. TRANSPORT AND COMMISSIONING

2.1. Using the pallet truck for the first time

Only operate the pallet truck with battery current. Rectified AC current will damage the electronic components. Cable connections to the battery (tow leads) must be less than 6 metres long.

Preparing the pallet truck for operation after delivery or transport.

Procedure:

- Check if the equipment is complete.
- Check the hydraulic oil level.
- Install the battery if necessary (where required), (see “4.4 Battery removal and installation” on page 22), do not damage the battery cable.
- Charge the battery, (see “4.3 Charging the battery” on page 20).

When the pallet truck is parked for an extended period, the surface of the tyres will flatten. The flattening will disappear after a short period of operation.

2.2. During brake-in

We recommend operating the machine under light load conditions for the first stage of operation to get the most from it. Especially the requirements given below should be observed while the machine is in a stage of 100 hours of operation.

- Please prevent the new battery from over-discharging during its initial use. Please charge when the power is less than 20%.
- Perform specified preventive maintenance services carefully and completely.
- Avoid sudden stop, starts or turns.
- Oil changes and lubrication are recommended to be performed earlier than specified.
- Limited load is 70~80% of the rated load.

3. OPERATION

3.1. Safety regulations for the operation of pallet trucks

Driver authorisation: The pallet truck may only be used by suitably trained personnel, who have demonstrated to the proprietor or his representative that they can drive and handle loads and have been authorised to operate the pallet truck by the proprietor or his representative.

Driver's rights, obligations and responsibilities: The driver must be informed of his duties and responsibilities and be instructed in the operation of the pallet truck and shall be familiar with the operator manual. The driver shall be afforded all due rights. Safety shoes must be worn with pedestrian-operated pallet trucks.

Unauthorised use of the pallet truck: The driver is responsible for the pallet truck during the time it is in use. He shall prevent unauthorised persons from driving or operating the pallet truck. It is forbidden to carry passengers or lift personnel.

Damage and faults: The supervisor must be immediately informed of any damage or faults to the pallet truck. Pallet trucks not safe for operation (e.g. wheel or brake problems) must not be used until the issues have been rectified.

Repairs: The driver must not carry out any repairs or alterations to the pallet truck without the necessary training and authorisation to do so. The driver must never disable or adjust safety mechanisms or switches.

Hazardous area: A hazardous area is defined as the area in which a person is at risk due to pallet truck movement, lifting operations, the load handler (e.g. forks or attachments) or the load itself. This also includes areas which can be reached by falling loads or lowering operating equipment.

Unauthorised persons must be kept away from the hazardous area.

Where there is danger to personnel, a warning must be sounded with sufficient notice. If unauthorised personnel are still within the hazardous area the pallet truck shall be brought to a halt immediately.

Safety devices and warning signs: Safety devices, warning signs and warning instructions shall be strictly observed.

3.2. Operate and run the pallet truck

3.2.1. Preparing

Before the pallet truck can be commissioned, operated or a load unit lifted, the driver must ensure that there is nobody within the hazardous area.

Checks and operations to be performed before starting daily work

- Visually inspect the entire pallet truck (in particular wheels and load handler) for obvious damage.

Switching on the pallet truck

- Turn on the power switch.
(• Insert the key in the key switch, turn it as far right as possible.)

3.2.2. Travel, steering, braking

Do not drive the pallet truck unless the panels are closed and properly locked.

1. Traction

Set the control handle to the travel zone (M).

Forward (V): press the “forward” button (2)

Backward (R): press the “reverse” button (1)

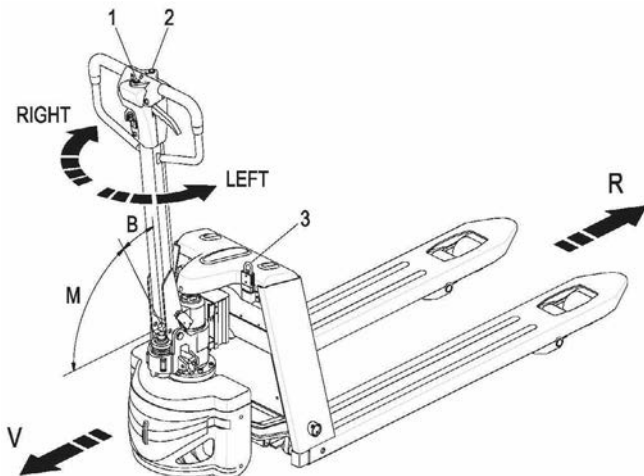

2. **Steering**
 - Turn the control shaft to the left or right.
3. **Braking emergency stop**

Pull out the puller (3), all electrical functions are cut out and the pallet truck automatically brakes.
4. **Automatic braking**

When the control handle is released it automatically returns to the upper brake zone (B) and the truck will brake.
5. **Regenerative braking**

If the travel switch is released, the pallet truck automatically brakes regeneratively. When the speed is below 1 km/h, the brake then applies and the motor brake stops.
6. **Inversion braking**

You can set the travel switch to the opposite direction when traveling. The pallet truck brakes regeneratively until it starts to move in the opposite direction.

Warning:

When driving on a hill or uneven surface, please lift the forks.

3.1.1. Lifting, transporting and depositing loads

Unsecured and incorrectly positioned loads can cause accidents.

- Instruct other people to move out of the hazardous area of the pallet truck. Stop working with the pallet truck if people do not leave the hazardous area.
- Only carry loads that have been correctly secured and positioned. Use suitable precautions to prevent parts of the load from tipping or falling down.
- Never stand underneath a raised load handler.
- Do not stand on the load handler.
- Do not lift other people on the load handler.
- Insert the forks as far as possible underneath the load.

Warning!

Before lifting a load unit the driver must make sure that it has been correctly stowed and does not exceed the pallet truck's capacity.

Do not lift long loads at an angle.

Lift

Press lowering lever (2) to the bottom. Lift the forks by moving the tiller (1) up and down until the desired lifting height is achieved. Reset the lowering lever (2) to its neutral position.

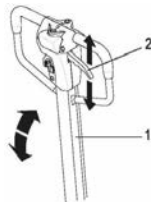

Lower

Lower the forks to their lowest position by pulling the lever (2) upwards.

3.1.2. Parking the pallet truck securely

- Lower the forks to the lowest position by pulling the lever (1) upwards.
- Turn off the power switch (2). (• Turn off the key switch (2) and remove the key.)
- Pull out the battery disconnecting (3). The pallet truck is parked.

Warning!

Park the pallet truck securely. Do not park on an inclined surface. Always fully lower the forks.

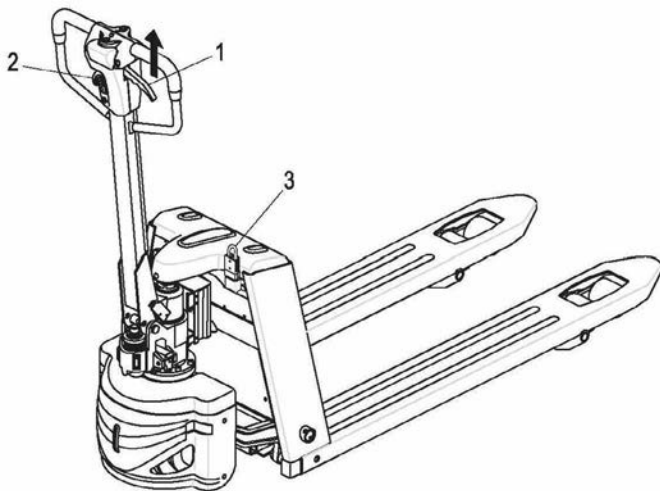

- Do not place any metal objects on the battery.
- Before charging, check all cables and plug connections for visible signs of damage.
- Before you start and finish charging make sure the power is turned OFF.
- It is essential to follow the safety regulations of the battery and charging station manufacturers.

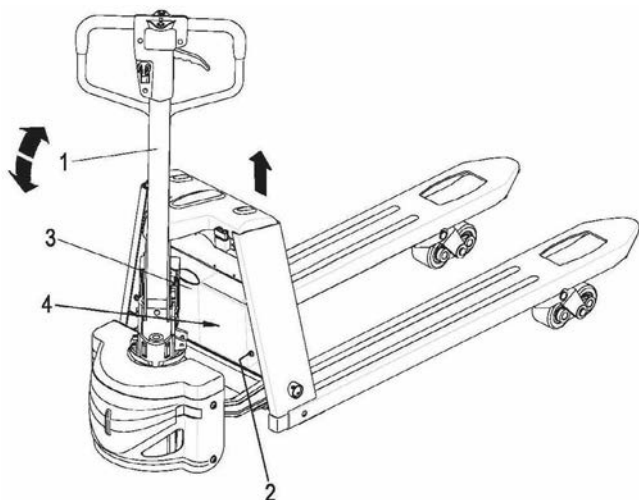

Charging step

- Check whether the condition is in conformity with “Safety regulations for charging the battery”.
- Park the pallet truck securely (see 3.2.4 Parking the pallet truck securely).
- Remove the battery plug (1).
- Connect the battery plug (1) to the charging lead of the stationary charger and turn on the charger.
- LED lamp (2):
 - If it is flashing red: the battery is charging.
 - If it is flashing green: the battery is fully charged.
 - If it is flashing yellow: check the charging circuit.

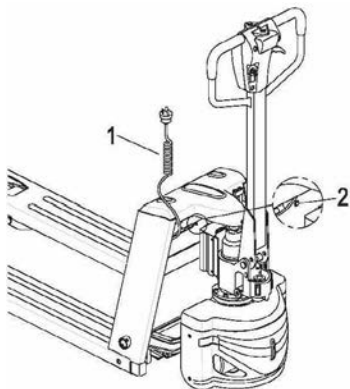

4.4. Battery removal and installation

Park the pallet truck securely (see 3.2.4 Parking the pallet truck securely) and turn off the power before removal and installation of the battery.

Battery removal and installation steps:

- a. Lift the forks to their highest position by moving the control shaft (1) up and down. Rotate the control shaft (1) a few degrees to the left or right.
- b. Remove two screws (2), take out the cover (3).
- c. Remove wire harness battery cable. Take out the battery (4).

Warning!

Place the cables correctly to avoid damage when you remove and install the battery.

To install the battery, follow the steps above in reverse order. Pay attention to the battery position and the cable connection. Make sure to replace the cables correctly to avoid damage.

4.5. Battery maintenance

Do not overuse the battery:

- If you use all the energy of the battery, you will shorten its operational life.
- If the battery indicator shows an orange light, the battery must be charged quickly.

Battery maintenance:

The battery cell covers must be kept dry and clean. The terminals and cable shoes must be clean, secure and have a light coating of dielectric grease. Batteries with non-insulated terminals must be covered with a non-skid insulation mat.

Warning!

1. Do not use dry cloth or fibre cloth to clean the battery, to avoid static electricity and risk of explosions.
2. Disconnect the battery plug.
3. Clean with wet cloth.
4. Wear glasses to protect your eyes, rubber overshoes and rubber gloves.

4.6. Battery disposal

Batteries may only be disposed of in accordance with national environmental protection regulations or disposal laws. The manufacturer's disposal instructions must be followed.

Batteries contain an acid solution which is poisonous and corrosive. Therefore, always wear protective clothing and eye protection when carrying out work on batteries. Above all avoid any contact with battery acid.

Nevertheless, should clothing, skin or eyes come in contact with acid, the affected parts should be rinsed with plenty of clean water. If the skin or eyes are affected, call a doctor immediately. Immediately neutralise any spilled battery acid.

Only batteries with a sealed battery container may be used.

The weight and dimensions of the battery have considerable effect on the operational safety of the pallet truck. Battery equipment may only be replaced with the agreement of the manufacturer.

5. PALLET TRUCK MAINTENANCE

5.1. Operational safety and environmental protection

- The servicing and inspection operations contained in this chapter must be performed in accordance with the intervals indicated in the servicing checklists.
- Any modification to the pallet truck assemblies, in particular the safety mechanisms, is prohibited. The operational speeds of the pallet truck must not be changed under any circumstances.
- Only original spare parts have been certified by our quality assurance department. To ensure a safe and reliable operation of the pallet truck, use only the manufacturer's spare parts. Used parts, oils and fuels must be disposed of in accordance with the relevant environmental protection regulations.
- Upon completion of inspection and servicing, carry out the activities listed in the "recommissioning" section.

5.2. Maintenance safety regulations

Maintenance personnel

Industrial pallet trucks must only be serviced and maintained by the manufacturer's trained personnel.

The manufacturer's service department has field technicians specially trained for these tasks. We therefore recommend a maintenance contract with the manufacturer's local service center.

Lifting and jacking up

When an industrial pallet truck is to be lifted, the lifting gear must only be secured to the points specially provided for this purpose.

When jacking up the pallet truck, take appropriate measures to prevent the pallet truck from slipping or tipping over (e.g. wedges, wooden blocks).

You may only work underneath a raised load handler if it is supported by a sufficiently strong chain.

Cleaning

Do not use flammable liquids to clean the industrial pallet truck.

Prior to cleaning, all safety measures required to prevent sparking (e.g. through short circuits) must be taken. For battery-operated pallet trucks, the battery connect cable must be removed.

Only weak suction or compressed air and non-conductive antistatic brushes may be used for cleaning electric or electronic assemblies.

If the pallet truck is to be cleaned with a water jet or a high-pressure cleaner, all electrical and electronic components must be carefully covered beforehand as moisture can cause malfunctions.

Do not clean with pressurised water.

After cleaning the pallet truck, carry out the activities detailed in the "recommissioning" section.

Electrical system

Only suitably trained personnel may operate the pallet truck's electrical system.

Before working on the electrical system, take all precautionary measures to avoid electric shocks.

Settings

When repairing or replacing hydraulic, electric or electronic components or assemblies, always note the pallet truck-specific settings.

Tyres

The quality of tyres affects the stability and performance of the pallet truck. When replacing factory fitted tyres, only use original manufacturer's spare parts, as otherwise the data plate specifications will not be kept.

When changing wheels and tyres, ensure that the pallet truck does not slew (e.g. when replacing wheels always replace left and right simultaneously).

5.3. Servicing and inspection

Thorough and expert servicing is one of the most important requirements for the safe operation of the industrial pallet truck. Failure to perform regular servicing can lead to pallet truck failure and poses a potential hazard to personnel and equipment.

The service intervals stated are based on single-shift operation under normal operating conditions. They must be reduced accordingly if the pallet truck is to be used in conditions of extreme dust, temperature fluctuations or multiple shifts.

The following maintenance checklist states the tasks and intervals after which they should be carried out. Maintenance intervals are defined as:

W = Every 50 service hours, at least weekly

A = Every 500 operating hours

B = Every 1000 operating hours, or at least annually

C = Every 2000 operating hours, or at least annually

W service intervals are to be performed by the customer.

In the run-in period - after approx. 100 service hours - or after repair work, the owner must check the wheel nuts/bolts and re-tighten if necessary.

5.3.1. Maintenance checklist

		Maintenance interval			
		W	A	B	C
Brake	Check magnetic brake air gap.			•	
Electrics	Test instruments, displays and control switches.	•			
	Test warning and safety device.		•		
	Make sure wire connections are secure and check for damage.			•	
	Test micro-switch setting.	•			
	Check relays.			•	
	Fix the motor and cable.			•	

		Maintenance interval			
		W	A	B	C
Power supply	Visually inspect battery.		•		
	Check battery cable connections are secure, grease terminals if necessary.			•	
Travel	Check the transmission for noise and leakage.			•	
	Check travel mechanism, adjust and lubricate if necessary. Check control handle recuperating function.		•		
	Check wheels for wear and damage.			•	
	Check wheel bearings and attachments.			•	
Pallet truck frame	Check pallet truck frame for damage.			•	
Hydraulic operation	Test hydraulic system.		•		
	Check cylinders and piston rods for damage and leaks, and make sure they are secure.			•	

5.3.2. Lubrication schedule

- ▼ Contact surfaces
- ⬇ Hydraulic oil filter neck
- ◆ Transmission oil filter neck

Fuels, coolants and lubricants

Handling consumables: Consumables must always be handled correctly. Follow the manufacturer's instructions.

Improper handling is hazardous to health, life and the environment. Consumables must only be stored in appropriate containers. They may be flammable and must therefore not come into contact with hot components or open flames.

Only use clean containers when filling up with consumables. Do not mix consumables of different grades. The only exception to this is when mixing is expressly stipulated in the operating instructions.

Avoid spillage. Spilled liquids must be removed immediately with suitable bonding agents and the bonding agent/consumable mixture must be disposed of in accordance with regulations.

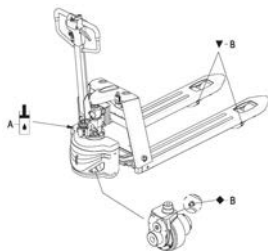

Code	Description	Used for
A	Hydraulic oil	Hydraulic system
B	Grease	Lubrication and gear case

5.3.3. Maintenance instructions

Prepare the pallet truck for maintenance and repairs

All necessary safety measures must be taken to avoid accidents when carrying out maintenance and repairs. The following preparations must be made:

- Park the pallet truck securely (see 3.2.4 Parking the pallet truck securely).
- Remove the key to prevent the pallet truck from accidentally starting.
- When working under a raised lift pallet truck, secure it to prevent it from tipping or sliding away.

Removing the cover

- Remove upper cover (2).
- Remove the four screws (1), lift off the lower cover (3).

Replacing the drive wheel

The drive wheel must only be replaced by authorised service personnel.

Recommissioning

The pallet truck may only be recommissioned after cleaning or repair work, once the following operations have been performed.

- Test the horn.
- Test the brake.
- Lubricate the pallet truck in accordance with the maintenance schedule.

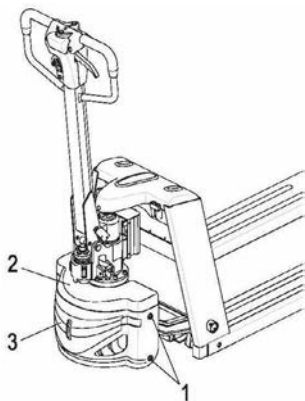

5.4. Decommissioning the industrial pallet truck

If the industrial pallet truck is to be decommissioned for more than two months, e.g. for operational reasons, it must be parked in a frost-free and dry location and all necessary measures must be taken before, during and after decommissioning as described.

On decommissioning the pallet truck must be jacked up so that all the wheels are clear of the ground. This is the only way of ensuring that the wheels and wheel bearings are not damaged. If the pallet truck is to be out of service for more than 6 months, further measures must be taken in consultation with the manufacturer's service department.

5.4.1. Prior to decommissioning

- Thoroughly clean the pallet truck.
- Check the brakes.
- Check the hydraulic oil level and replenish as necessary (see 5.3.3 Maintenance instructions).
- Apply a thin layer of oil or grease to any non-painted mechanical components.
- Lubricate the pallet truck in accordance with the maintenance schedule (see 5.3.2 Lubrication schedule).
- Charge the battery (see 4.3 Charging the battery).
- Disconnect the battery, clean it and apply grease to the terminals.
- In addition, follow the battery manufacturer's instructions.
- Spray all exposed electrical contacts with a suitable contact spray.

Warning!

Charge the battery.

The battery must be charged at regular intervals to avoid depletion of the battery through self-discharge. The sulphatisation would destroy the battery.

5.4.2. Restoring the pallet truck to operation after decommissioning

- Thoroughly clean the pallet truck.
- Lubricate the pallet truck in accordance with the maintenance schedule (see 5.3.2 Lubrication schedule).
- Clean the battery, grease the terminals and connect the battery.
- Charge the battery (see 4.3 Charging the battery).
- Check hydraulic oil for condensed water and replace if necessary.
- Start up the pallet truck (see 3.2 Operate and run the pallet truck).

If there are switching problems in the electrical system, apply contact spray to the exposed contacts and remove any oxide layers on the contacts of the operating controls by applying them repeatedly.

Perform several brake tests immediately after re-commissioning the pallet truck.

5.5. Safety checks to be performed at regular intervals and following any unusual incidents

Carry out a safety check in accordance with national regulations. The pallet truck must be inspected by a qualified inspector once a year (refer to national regulations) or after any unusual event. The inspector shall assess the condition of the pallet truck from purely a safety viewpoint, without regard to operational or economic circumstances. The inspector shall be

sufficiently instructed and experienced to be able to assess the condition of the pallet truck and the effectiveness of the safety mechanisms based on the technical regulations and principles governing the inspection of pallet trucks.

A thorough test of the pallet truck must be undertaken with regard to its technical condition from a safety aspect. The pallet truck must also be examined for damage caused by possible improper use. A test report shall be provided. The test results must be kept for at least the next 2 inspections.

The owner is responsible for ensuring that faults are immediately rectified.

A test plate is attached to the pallet truck as proof that it has passed the safety inspection. This plate indicates the due date for the next inspection.

5.6. Final decommissioning, disposal

Final, proper decommissioning or disposal of the pallet truck must be performed in accordance with the regulations of the country of application. In particular, regulations governing the disposal of batteries, fuels and electronic and electrical systems must be observed.

6. TROUBLESHOOTING

This chapter is designed to help the user identify and rectify basic faults or the results of incorrect operation. When locating a fault, proceed in the order shown in the table.

Fault	Possible cause	Action
Pallet truck does not start	<ul style="list-style-type: none">• Key switch in "off" position• Battery charge too low• Pallet truck in charge mode	<ul style="list-style-type: none">• Set key switch to "on"• Check battery charge, charge battery if necessary• Interrupt charging
Load can not be lifted	<ul style="list-style-type: none">• Hydraulic oil level too low• Excessive load	<ul style="list-style-type: none">• Check the hydraulic oil level• Note maximum capacity (see data plate)

If the fault cannot be rectified after carrying out the remedial procedure, notify the supplier, as any further troubleshooting can only be performed by specially trained and qualified service personnel.



Your distributor:

